



# Wood Mead

## CHESWICK VILLAGE

APPROXIMATE FLOOR AREA  
87 SQM / 932 SQFT



GROUND FLOOR



FIRST FLOOR

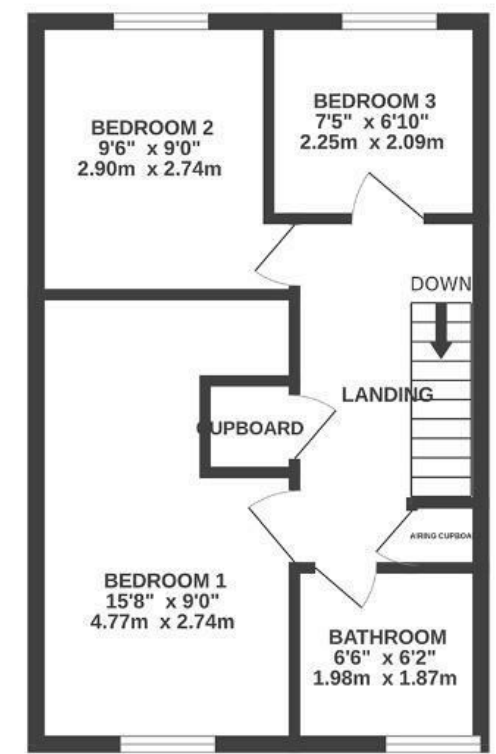

Boardwalk

# Wood Mead

## CHESWICK VILLAGE, BRISTOL



£375,000



3 Bedrooms



BS16 1GQ



3 Bathrooms

*"We love living here! It is so handy to only have a few minutes to walk for the school run, to have so many buses in UWE to reach the city centre within twenty minutes, and to not be far away from M4, M5, and M32. We love that this area is so family friendly and close to nature. The best day is to stop at the playground a few yards away, then get a pizza at Pepenero or a coffee at BTP, and finish with a nice walk in Stoke Park!"*

